

Optimise design and performance of pneumatic systems.

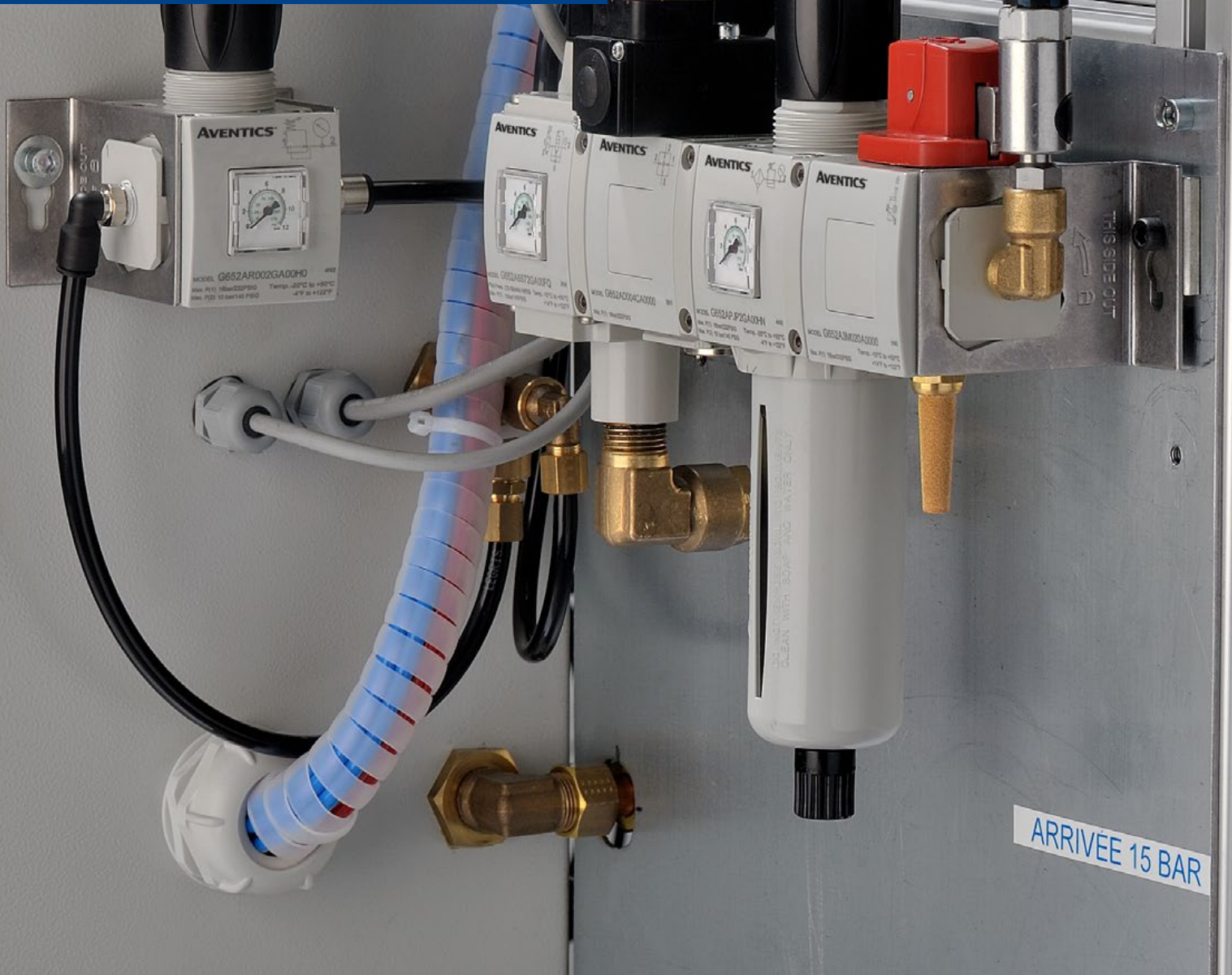

**AVENTICS™ Series 651, 652, 653**  
High flow rates and broad range of Air Preparation systems enable easier selection, design and system optimisation.



## AVENTICS Series 651, 652, 653 aluminium air preparation

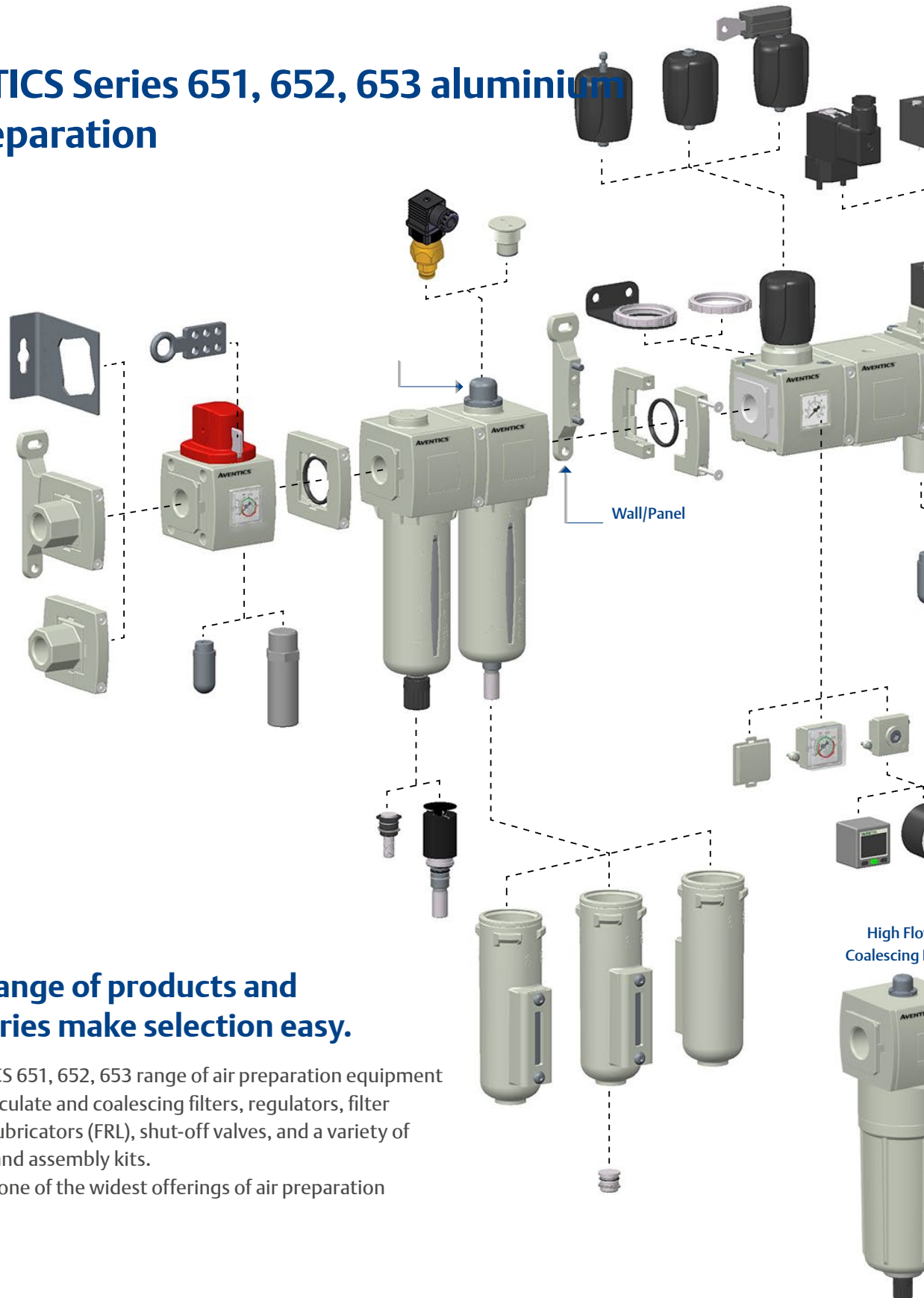

### Broad range of products and accessories make selection easy.

The AVENTICS 651, 652, 653 range of air preparation equipment include particulate and coalescing filters, regulators, filter regulators, lubricators (FRL), shut-off valves, and a variety of accessories and assembly kits.

The range is one of the widest offerings of air preparation

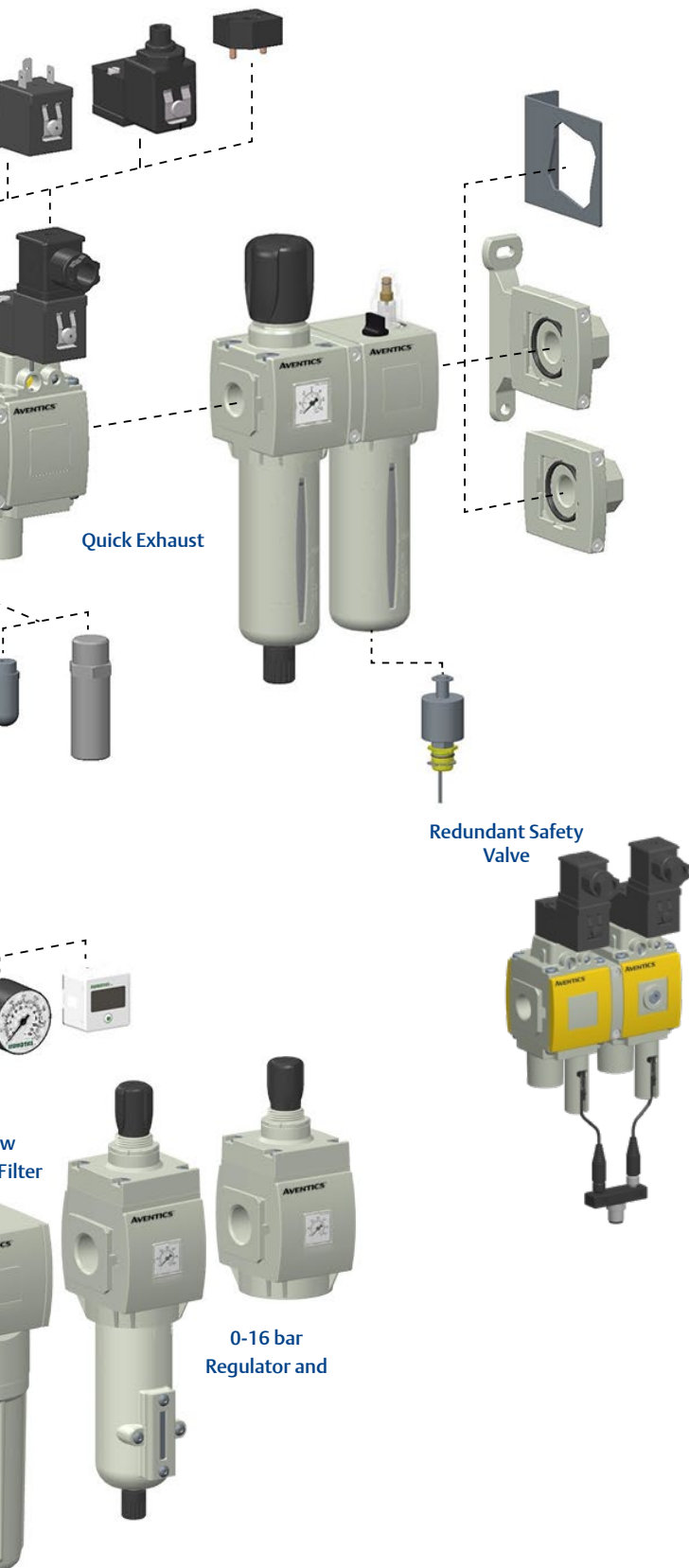

<b>Port sizes</b>	1/8, 1/4, 3/8, 1/2, 3/4, 1"
<b>Maximum flow</b>	Up to 10 000 l/min
<b>Operating temperature</b>	-20 to +50°C (-40 to +80°C optional)
<b>Regulated pressure</b>	0.2 to 10 bar (16 bar optional)
<b>Fluid</b>	Air or inert gas
<b>Certifications</b>	ATEX, CUTR
<b>Standards</b>	Complies to ISO 8573.1:2010 and ISO 12500 air purity classification

## Particulate Filter



		SERIES		651		652			653	
Filter Element	Bowls	Drain Type	1/8"	1/4"	1/4"	3/8"	1/2"	3/4"	1"	
Flow (l/min)			920	1410	2250	3390	3700	4700	5000	
25 Micron	Polycarbonate	Semi-Auto/Manual	G651ABJP1JA000N	G651ABJP2JA000N	G652ABJP2JA000N	G652ABJP3JA000N	G652ABJP4JA000N	G653ABJP5JA000N	G653ABJP6JA000N	
		Automatic	G651ABJP1JA000A	G651ABJP2JA000A	G652ABJP2JA000A	G652ABJP3JA000A	G652ABJP4JA000A	G653ABJP5JA000A	G653ABJP6JA000A	
	Metal without Sight Gauge	Semi-Auto/Manual	G651ABJK1JA000N	G651ABJK2JA000N	G652ABJK2JA000N	G652ABJK3JA000N	G652ABJK4JA000N	G653ABJK5JA000N	G653ABJK6JA000N	
		Automatic	G651ABJK1JA000A	G651ABJK2JA000A	G652ABJK2JA000A	G652ABJK3JA000A	G652ABJK4JA000A	G653ABJK5JA000A	G653ABJK6JA000A	
	Metal with Glass Sight Gauge	Semi-Auto/Manual	G651ABJL1JA000N	G651ABJL2JA000N	G652ABJL2JA000N	G652ABJL3JA000N	G652ABJL4JA000N	G653ABJL5JA000N	G653ABJL6JA000N	
		Automatic	G651ABJL1JA000A	G651ABJL2JA000A	G652ABJL2JA000A	G652ABJL3JA000A	G652ABJL4JA000A	G653ABJL5JA000A	G653ABJL6JA000A	
Flow (l/min)			885	1250	2020	2190	2290	4000	4250	
5 Micron	Polycarbonate	Semi-Auto/Manual	G651ABBP1JA000N	G651ABBP2JA000N	G652ABBP2JA000N	G652ABBP3JA000N	G652ABBP4JA000N	G653ABBP5JA000N	G653ABBP6JA000N	
		Automatic	G651ABBP1JA000A	G651ABBP2JA000A	G652ABBP2JA000A	G652ABBP3JA000A	G652ABBP4JA000A	G653ABBP5JA000A	G653ABBP6JA000A	
	Metal without Sight Gauge	Semi-Auto/Manual	G651ABBK1JA000N	G651ABBK2JA000N	G652ABBK2JA000N	G652ABBK3JA000N	G652ABBK4JA000N	G653ABBK5JA000N	G653ABBK6JA000N	
		Automatic	G651ABBK1JA000A	G651ABBK2JA000A	G652ABBK2JA000A	G652ABBK3JA000A	G652ABBK4JA000A	G653ABBK5JA000A	G653ABBK6JA000A	
	Metal with Glass Sight Gauge	Semi-Auto/Manual	G651ABBL1JA000N	G651ABBL2JA000N	G652ABBL2JA000N	G652ABBL3JA000N	G652ABBL4JA000N	G653ABBL5JA000N	G653ABBL6JA000N	
		Automatic	G651ABBL1JA000A	G651ABBL2JA000A	G652ABBL2JA000A	G652ABBL3JA000A	G652ABBL4JA000A	G653ABBL5JA000A	G653ABBL6JA000A	

## Regulator



		SERIES		651		652			653	
Regulation Zone	Gauge	1/8"	1/4"	1/4"	3/8"	1/2"	3/4"	1"		
Flow (l/min)		800	2060	4120	6530	7000	9000	11500		
0-10 Bar	Flat Gauge	G651AR001GA000H	G651AR002GA000H	G652AR002GA000H	G652AR003GA000H	G652AR004GA000H	G653AR005GA000H	G653AR006GA000H		
	Port Plate RC 1/8	G651AR001PA000H	G651AR002PA000H	G652AR002PA000H	G652AR003PA000H	G652AR004PA000H	G653AR005PA000H	G653AR006PA000H		
	Round Gauge	G651AR001QA000H	G651AR002QA000H	G652AR002QA000H	G652AR003QA000H	G652AR004QA000H	G653AR005QA000H	G653AR006QA000H		
0-16 BAR	Flat Gauge						G653AR005GA000N	G653AR006GA000N		
	Port Plate RC 1/8						G653AR005PA000N	G653AR006PA000N		
	Round Gauge						G653AR005QA000N	G653AR006QA000N		

## Particulate Filter-Regulator



		SERIES		651		652			653		
Regulation	Gauge	Filter	Bowls	Drain Type	1/8"	1/4"	1/4"	3/8"	1/2"	3/4"	1"
Flow (l/min)			730	2360	4120	5420	5500	9000	10000		
0-10 BAR	Flat Gauge	25 Micron	Polycarbonate	Semi-Auto	G651APJP1GA00HN	G651APJP2GA00HN	G652APJP2GA00HN	G652APJP3GA00HN	G652APJP4GA00HN	G653APJP5GA00HN	G653APJP6GA00HN
				Automatic	G651APJP1GA00HA	G651APJP2GA00HA	G652APJP2GA00HA	G652APJP3GA00HA	G652APJP4GA00HA	G653APJP5GA00HA	G653APJP6GA00HA
	Metal without Sight Gauge	Semi-Auto	G651APJK1GA00HN	G651APJK2GA00HN	G652APJK2GA00HN	G652APJK3GA00HN	G652APJK4GA00HN	G653APJK5GA00HN	G653APJK6GA00HN		
		Automatic	G651APJK1GA00HA	G651APJK2GA00HA	G652APJK2GA00HA	G652APJK3GA00HA	G652APJK4GA00HA	G653APJK5GA00HA	G653APJK6GA00HA		
	Metal with Glass Sight Gauge	Semi-Auto	G651APJL1GA00HN	G651APJL2GA00HN	G652APJL2GA00HN	G652APJL3GA00HN	G652APJL4GA00HN	G653APJL5GA00HN	G653APJL6GA00HN		
		Automatic	G651APJL1GA00HA	G651APJL2GA00HA	G652APJL2GA00HA	G652APJL3GA00HA	G652APJL4GA00HA	G653APJL5GA00HA	G653APJL6GA00HA		
Flow (l/min)			710	2240	3800	4450	4490	8900	9000		
0-10 BAR	Flat Gauge	5 Micron	Polycarbonate	Semi-Auto	G651APBP1GA00HN	G651APBP2GA00HN	G652APBP2GA00HN	G652APBP3GA00HN	G652APBP4GA00HN	G653APBP5GA00HN	G653APBP6GA00HN
				Automatic	G651APBP1GA00HA	G651APBP2GA00HA	G652APBP2GA00HA	G652APBP3GA00HA	G652APBP4GA00HA	G653APBP5GA00HA	G653APBP6GA00HA
	Metal without Sight Gauge	Semi-Auto	G651APBK1GA00HN	G651APBK2GA00HN	G652APBK2GA00HN	G652APBK3GA00HN	G652APBK4GA00HN	G653APBK5GA00HN	G653APBK6GA00HN		
		Automatic	G651APBK1GA00HA	G651APBK2GA00HA	G652APBK2GA00HA	G652APBK3GA00HA	G652APBK4GA00HA	G653APBK5GA00HA	G653APBK6GA00HA		
	Metal with Glass Sight Gauge	Semi-Auto	G651APBL1GA00HN	G651APBL2GA00HN	G652APBL2GA00HN	G652APBL3GA00HN	G652APBL4GA00HN	G653APBL5GA00HN	G653APBL6GA00HN		
		Automatic	G651APBL1GA00HA	G651APBL2GA00HA	G652APBL2GA00HA	G652APBL3GA00HA	G652APBL4GA00HA	G653APBL5GA00HA	G653APBL6GA00HA		
0-16 BAR	Integrated Flat Gauge	25 Micron	Metal without Sight Gauge	Semi-Auto						G653APJK5GA00NN	G653APJK6GA00NN
				Semi-Auto							G653APJL5GA00NN
Flow (l/min)								8900	9000		
0-16 BAR	Integrated Flat Gauge	5 Micron	Metal without Sight Gauge	Semi-Auto						G653APBK5GA00NN	G653APBK6GA00NN
				Semi-Auto							G653APBL5GA00NN



## Lubricator

SERIES	651		652			653	
Bowls	1/8"	1/4"	1/4"	3/8"	1/2"	3/4"	1"
Flow (l/min)	900	1940	2780	5000	5100	13000	13000
Polycarbonate	G651AL0P10A0000	G651AL0P20A0000	G652AL0P20A0000	G652AL0P30A0000	G652AL0P40A0000	G653AL0P50A0000	G653AL0P60A0000
Metal without Sight Gauge	G651AL0K10A0000	G651AL0K20A0000	G652AL0K20A0000	G652AL0K30A0000	G652AL0K40A0000	G653AL0K50A0000	G653AL0K60A0000
Metal with Glass Sight Gauge	G651AL0L10A0000	G651AL0L20A0000	G652AL0L20A0000	G652AL0L30A0000	G652AL0L40A0000	G653AL0L50A0000	G653AL0L60A0000

## 3/2 Shut-Off Valve



SERIES	651		652			653	
Bowls	1/8"	1/4"	1/4"	3/8"	1/2"	3/4"	1"
Flow (l/min)	1440	4720	4300	8800	11400	13300	13300
Without Option	G651A3M010A0000	G651A3M020A0000	G652A3M020A0000	G652A3M030A0000	G652A3M040A0000	G653A3M050A0000	G653A3M060A0000
With Metal Muffler	G651A3M01011100	G651A3M02011100	G652A3M02011100	G652A3M03011100	G652A3M04011100	G653A3M05011100	G653A3M06011100
With Polyethylene Muffler	G651A3M01012200	G651A3M02012200	G652A3M02012200	G652A3M03012200	G652A3M04012200	G653A3M05012200	G653A3M06012200

## Diverter Block



651	652	653
1/4"	1/2"	1"
G651AD002CA0000	G652AD004CA0000	G653AD006CA0000



	0,2 - 6 bar	0,5 - 10 bar	0,5 - 16 bar
With Protection	34900028	34900031	34900034
Without Protection	34900027	34900030	34900033

## Slow-Start / Quick Exhaust



SERIES	651		652			653		
Product Type	Pilot Type	1/8"	1/4"	1/4"	3/8"	1/2"	3/4"	1"
	Flow (l/min)	780	1000	1500	3750	4650	7280	8230
2/2 SLOW START	Air Piloted Internal	G651A4P010A0000	G651A4P020A0000	G652A4P020A0000	G652A4P030A0000	G652A4P040A0000	G653A4P050A0000	G653A4P060A0000
	Solenoid Pilot Operated	G651A4S910A0000	G651A4S920A0000	G652A4S920A0000	G652A4S930A0000	G652A4S940A0000	G653A4S950A0000	G653A4S960A0000
3/2 QUICK EXHAUST	Solenoid Pilot Operated	G651A5S910A0000	G651A5S920A0000	G652A5S920A0000	G652A5S930A0000	G652A5S940A0000	G653A5S950A0000	G653A5S960A0000
3/2 SLOW-START/ QUICK EXHAUST	Solenoid Pilot Operated	G651A6S910A0000	G651A6S920A0000	G652A6S920A0000	G652A6S930A0000	G652A6S940A0000	G653A6S950A0000	G653A6S960A0000

## Pilot For Slow-Start / Quick Exhaust

SERIES	Pilot Series	Pilot Type	Code	Coil	Code	Connector Type	Coil	Code	
651 652		Without Manual Operator	1899007		24 V AC 50/60 Hz	43004416	Without LED	24V 50/60 Hz 24V DC	88122404
					115 V AC 50/60 Hz	43004419			88122405
					230 V AC 50/60 Hz	43004422			88122407
					24 V DC	43004166			88122410
651 652		Without Manual Operator	19090005		24 V AC 50/60 Hz	43004469	Without LED	24V 50/60 Hz 24V DC	88122602
					115 V AC 50/60 Hz	43004471			88122603
					230 V AC 50/60 Hz	43004472			88122605
					24 V DC	43004473			88122608
653		Without Manual Operator	19291010		24 V AC 50/60 Hz	43005604	Without LED	24V 50/60 Hz 24V DC	88122602
					115 V AC 50/60 Hz	43005617			88122603
					230 V AC 50/60 Hz	43005627			88122605
					24 V DC	43005642			88122608
653		Impulse	19291012		24 V AC 50/60 Hz	43005604	With LED	24V 50/60 Hz 24V DC	88122602
					115 V AC 50/60 Hz	43005617			88122603
					230 V AC 50/60 Hz	43005627			88122605
					24 V DC	43005642			88122608



For further information on these products, visit [www.Emerson.com/AVENTICS](http://www.Emerson.com/AVENTICS)

## Mountings

	Description	Series	Code
	Body-to-Body Assembly Clamps with NBR Seals	651	P651AT504958001
		652	P652AT502466001
		653	P653AT507291001
	Wall/Panel Bracket Kit	651	P699AT502467001
		652	
		653	
	Side Mounting Brackets	651	P651AT503860001
		652	P652AT503860002
		653	P653AT503860003
	Panel Nut for Regulator and Filter-Regulator	651	P651AT513928001
		652	P652AT513177001
	Panel nut & Bracket for Regulator and Filter-Regulator	651	P651AT503861001
		652	P652AT503861002
	End Plate Kit G1/4 (651) G1/2 (652) and G1 (653)	651	T651AT504959002
		652	T652AT502468002
		653	T653AT507292002

## Accessories and Spare Parts

	Description	Product	Series	Series	Code	
	Metal Muffler	Shut-off	G1/4	651	M2MB	
		Quick exhaust	G1/4			
	Polyethylene Muffler	Shut-off	G1/4		652	34600407
		Quick exhaust	G1/4			
	Metal Muffler	Shut-off	G1/4	653		M2MB
		Quick exhaust	G1/2			
	Polyethylene Muffler	Shut-off	G1/4		652	34600407
		Quick exhaust	G1/2			
	Metal Muffler	Shut-off	G3/8	653		M3MB
		Quick exhaust	G1			
	Polyethylene Muffler	Shut-off	G3/8		34600408	

	Description	Series	Code
	Round Manometer Adapter Port Plate RC1/8	651 652 653	M699AG440510002
	Pressure Range indicator Red/Green for Integrated Flat Gauge	651 652 653	M699AG500179001
	Integrated Gauge - 651/652/653 Series: 0-12 bar Scale with NBR Seals	651 652 653	M699AG438047001
	Round Gauge - 0-4 bar 1/8 ISO 7/1 Rc and 40mm Face Diameter	651 652 653	34300015
	Round Gauge - 0-10 bar 1/8 ISO 7/1 Rc and 40mm Face Diameter		34300014
	Round Gauge - 0-12 bar 1/8 ISO 7/1 Rc and 40mm Face Diameter		34300041
	Round Gauge - 0-25 bar 1/8 ISO 7/1 Rc and 50mm Face Diameter		34200063
	Round Gauge - 0-4 bar 1/8 ISO 7/1 Rc and 50mm Face Diameter		34200061
	Round Gauge - 0-12 bar 1/8 ISO 7/1 Rc and 50mm Face Diameter		34200062
	Round Gauge - 0-16 bar 1/8 ISO 7/1 Rc and 50mm Face Diameter		34200997
	Key Lock Device	651 652 653	M699AY438663001
	Digital Pressure Switch PNP M8 with Cable 1/8 ISO 7/1 RC	651 652 653	DPS280PRQ8
	Bowl and Drain Assembly - Includes Polycarbonate Bowl/Guard and Semi-Automatic Drain Assembly (NBR Seals)	651	M651AU514009001
		652	M652AU513311001
		653	M653AU14103001

## 651, 652, 653 Series Quick Assemblies



### Filter-Regulator + Lubricator

- 25 $\mu$  filter element
- Integrated Manometer
- Polycarbonate Bowl
- 0-10 Bar Regulation Zone
- Semi-Automatic/Manual Drain

Series	Port Size	Code
651	1/8"	A651A0000000400
	1/4"	A651A0000000401
652	1/4"	A652A0000000001
	3/8"	A652A0000000002
653	1/2"	A652A0000000003
	3/4"	A653A0000000600
	1"	A653A0000000601



### 3/2 Shut-Off + Filter-Regulator

- 25 $\mu$  filter element
- Integrated Manometer
- Polycarbonate Bowl
- 0-10 Bar Regulation Zone
- Semi-Automatic/Manual Drain

Series	Port Size	Code
651	1/8"	A651A0000003632
	1/4"	A651A0000002493
652	1/4"	A652A0000003637
	3/8"	A652A0000003638
653	1/2"	A652A0000001048
	3/4"	A653A0000000696
	1"	A653A0000000697



### 3/2 Shut-Off + Filter-Regulator + Lubricator

- 25 $\mu$  filter element
- Integrated Manometer
- Polycarbonate Bowl
- 0-10 Bar Regulation Zone

Series	Port Size	Code
651	1/8"	A651A0000003390
	1/4"	A651A0000003391
652	1/4"	A652A0000003392
	3/8"	A652A0000003393
653	1/2"	A652A0000002941
	3/4"	A653A0000000698
	1"	A653A0000000699



### 3/2 Shut-Off + Filter-Regulator + 3/2 Slow-Start/Quick-Exhaust

- 25 $\mu$  filter element
- Integrated Manometer
- Polycarbonate Bowl
- 0-10 Bar Regulation Zone
- Semi-Automatic/Manual Drain

Series	Port Size	Code
651	1/8"	A651A0000003633
	1/4"	A651A0000003634
652	1/4"	A652A0000003639
	3/8"	A652A0000003640
653	1/2"	A652A0000003641
	3/4"	A653A0000000700
	1"	A653A0000000701



### 3/2 Shut-Off + Filter-Regulator + 3/2 Slow-Start

- 25 $\mu$  filter element
- Integrated Manometer
- Polycarbonate Bowl
- 0-10 Bar Regulation Zone
- Semi-Automatic/Manual Drain

Series	Port Size	Code
651	1/8"	A651A0000003635
	1/4"	A651A0000003636
652	1/4"	A652A0000003642
	3/8"	A652A0000003643
653	1/2"	A652A0000003644
	3/4"	A653A0000000702
	1"	A653A0000000703



For further information on these products, visit [www.Emerson.com/AVENTICS](http://www.Emerson.com/AVENTICS)

You can choose from one of the most complete air preparation product range in the market and only have to work with one supplier.

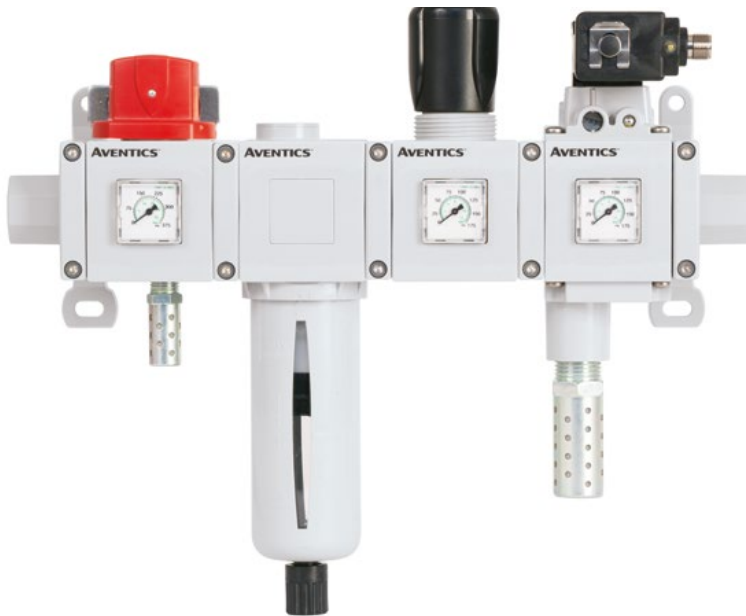

**AVENTICS™**

Where flow control meets pneumatics to create fluid automation solutions that maximise efficiencies, optimise applications, and enable customers to fulfil their true potential.

Our extensive product lines include a broad range of solenoid valves, pressure operated valves, pneumatic valves, valve

Visit us: [Emerson.com/aventics](https://www.emerson.com/aventics)

Your local contact: [Emerson.com/contact](https://www.emerson.com/contact)



[Emerson.com](https://www.emerson.com)



[Facebook.com/EmersonAutomationSolutions](https://www.facebook.com/EmersonAutomationSolutions)



[LinkedIn.com/company/Emerson-Automation-](https://www.linkedin.com/company/Emerson-Automation-Solutions)



[Solutions](https://www.linkedin.com/company/Emerson-Automation-Solutions)

The Emerson logo is a trademark and service mark of Emerson Electric Co. Brand logotype are registered trademarks of one of the Emerson family of companies. All other marks are the property of their respective owners. © 2021 Emerson Electric Co. All rights reserved. BR000035ENGB-02\_04-21



**CONSIDER IT SOLVED™**

**MorrellGroup**  
Evolution in Controls

[www.morrell-group.com](https://www.morrell-group.com) 248-373-1600